

Scan the QR code to download APP



MOBIK Android

Install APP

(Android)

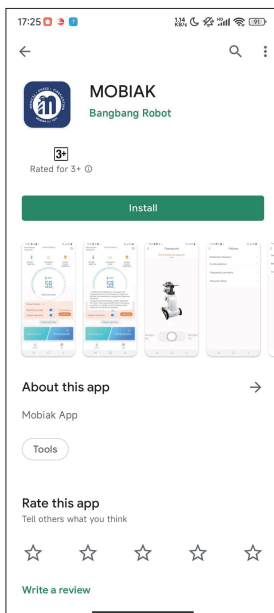

The above screen is displayed after scanning, click **Install** to install the mobile application. Open the mobile application after finishing the installation.

Connect Device

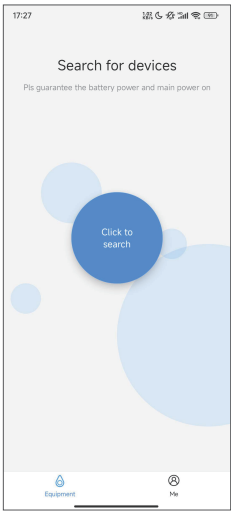

Click [Click to search](#) on the above screen to search device.

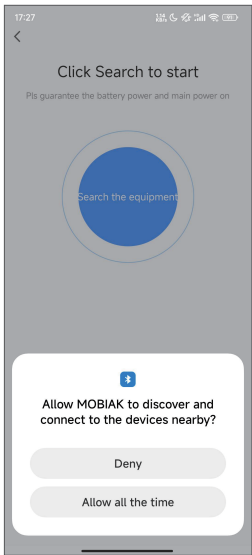

Note: Obtain phone permissions

Click [Allow all the time](#) on the above screen to turn on your mobile's Bluetooth

APP operation guide of the electric wheelchair

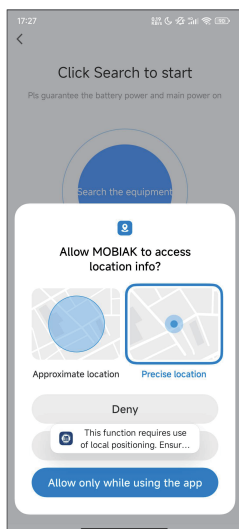

Note: Obtain phone permissions

Click [Allow only while using the app](#) on the above screen to turn on your phone's location.

APP operation guide of the electric wheelchair

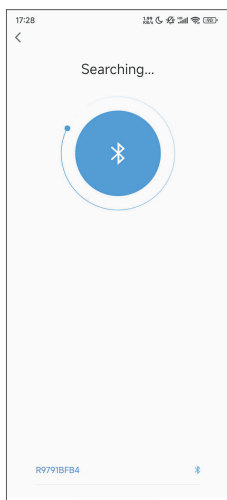

Once the above operation has been done mobile application start searching for the device.

Click R9791BFB4 to pair the mobile application and device.

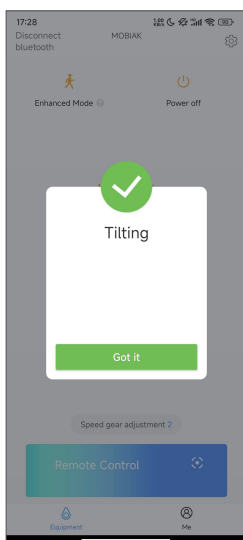



Note: When the wheelchair is in lock mode, display this interface. After turning on the wheelchair, enter the lock mode automatically. Only use the app after unlocking on the wheelchair.

The above screen indicates a successful connection.

Click GOT IT in the above screen to access status screen of the electric wheelchair

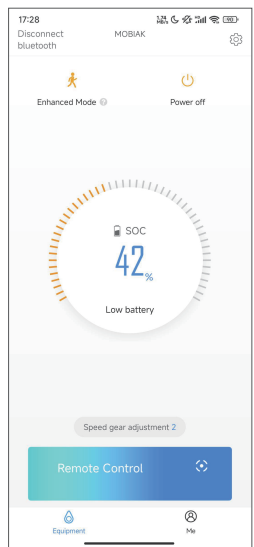
APP operation guide of the electric wheelchair

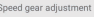

- Click  to turn off the device.
- Click  to disconnect the bluetooth connection.
- Click  to adjust the device speed.(Adjustable speed in 5 gears)

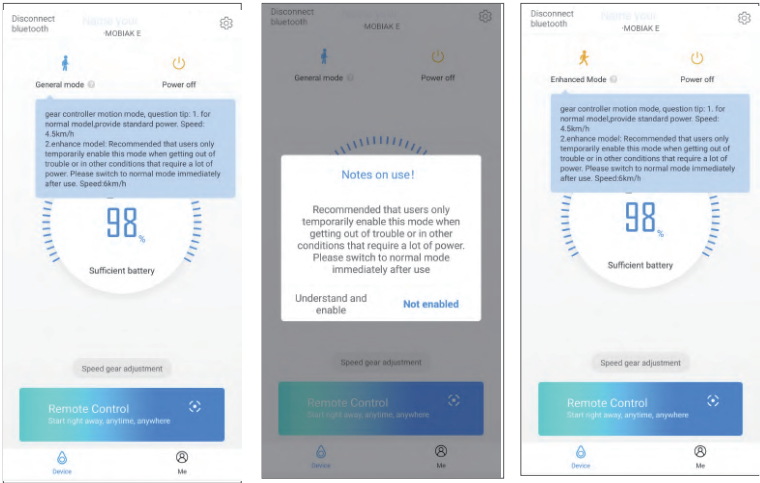

- Click  in status screen to access enhanced mode adjustment and general mode adjustment.(General mode speed:4.5km/h, enhanced mode speed:6km/h)

APP operation guide of the electric wheelchair

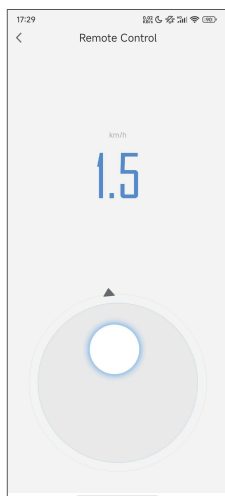

Click **Remote Control** in the status screen to access the remote control mode

Circle up to move forward, down to move back, left to turn left, right to turn right.

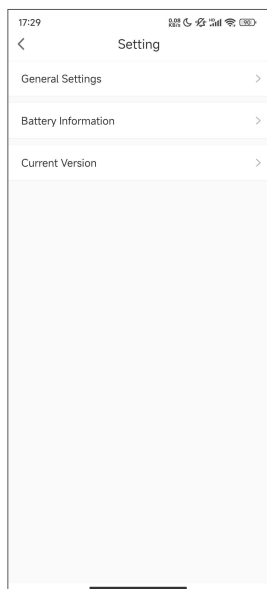

Click  in the top right corner to access the setting screen

APP operation guide of the electric wheelchair

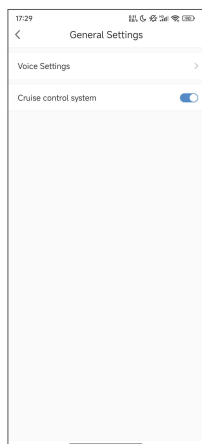

Click “General Settings” in the setting screen to access the general settings mode.

Cruise control system: slide left to turn off cruise control, slide right to turn on cruise control.

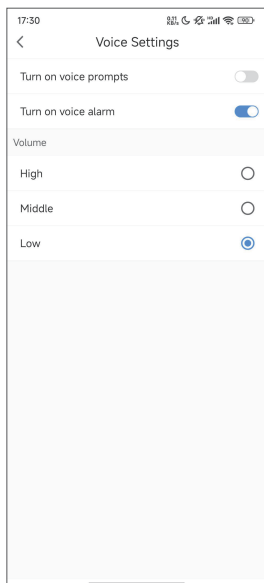

Click”Vocice settings” in the General settings to access the vocice settings mode.

Turn on voice prompts: slide left to turn off voice, slide right to turn on voice.

Turn on vocie alarm: slide left to turn off voice, slide right to turn on voice.

Adjustable 3-step volume:High,Middle,Low.

APP operation guide of the electric wheelchair

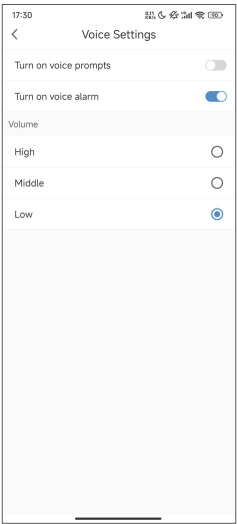

Click “Battery information” in the setting screen to access battery information screen.
Shows battery power percentage and battery status.

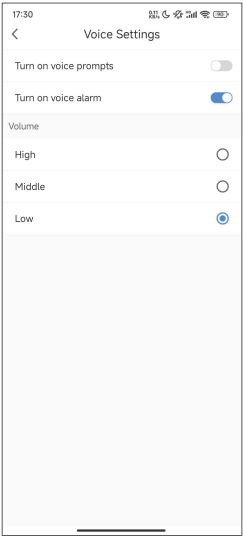

Click “Current Version” in the setting screen to access version upgrade mode.
Show current device version.
Click [CHECK FOR UPDATE](#) to upgrade version of device.